



Republic Brass Sales, Inc.  
 619.229.8304  
 6566 Federal Blvd  
 Lemon Grove, CA 91945  
 www.republicbrasssales.com

# PIPE HANGER TYPE 4

Specification: NAVSEA DWG 810-4714432

Neoprene Liner IAW ASTM D-2000-75E Shore A 60

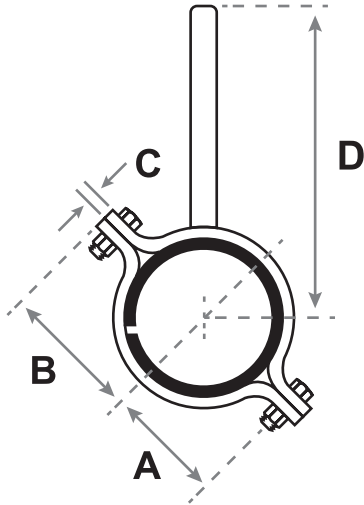

NOMINAL PIPE SIZE	RBS P/N	A	B	C	D	BOLT SIZE
1/4"	HANGX4-040	1.188	1.688	0.188	15 MAX	3/8
3/8"	HANGX4-060	1.250	1.750	0.188	15 MAX	3/8
1/2"	HANGX4-100	1.500	2.000	0.188	15 MAX	3/8
3/4"	HANGX4-150	1.688	2.188	0.188	15 MAX	3/8
1"	HANGX4-200	1.813	2.313	0.188	15 MAX	3/8
1 1/4"	HANGX4-250	2.000	2.500	0.188	15 MAX	3/8
1 1/2"	HANGX4-300	2.125	2.625	0.188	15 MAX	3/8
2"	HANGX4-400	2.500	3.125	0.250	15 MAX	1/2
2 1/2"	HANGX4-450	2.813	3.438	0.250	15 MAX	1/2
3"	HANGX4-500	3.125	3.750	0.250	15 MAX	1/2
3 1/2"	HANGX4-550	3.375	4.000	0.250	15 MAX	1/2
4"	HANGX4-600	3.750	4.500	0.250	15 MAX	5/8
5"	HANGX4-700	4.375	5.375	0.250	15 MAX	3/4
6"	HANGX4-800	4.938	5.938	0.250	15 MAX	3/4
8"	HANGX4-900	6.125	7.125	0.375	15 MAX	3/4
10"	HANGX4-1000	7.188	8.188	0.375	15 MAX	1
12"	HANGX4-1100	8.375	9.625	0.375	15 MAX	1

NOTES: For P/N replace X for **CS** for A-36 Steel, **A** for 6061 Aluminum, **SS** for Stainless Steel.

1/4" and 3/8" NPS Hangers have 1/8" liners; all other sizes have 1/4" liners.

